



WARNING:

CHOKING HAZARD-Small parts.
Not for children under 4 years.

33287 Asst.

AGES
4+

Lite-Brite®



x3
1.5V AA
R6 size

**BATTERIES
REQUIRED
NOT INCLUDED**

Alkaline batteries
recommended.
Phillips/cross head
screwdriver
(not included)
needed to insert
batteries.

LED Travel

Includes LED Travel playset, 100 pegs and 4 pattern sheets.





TO INSTALL BATTERIES:

1

Using Phillips/cross head screwdriver, loosen screw in battery compartment cover (screw stays attached to cover). Remove cover.

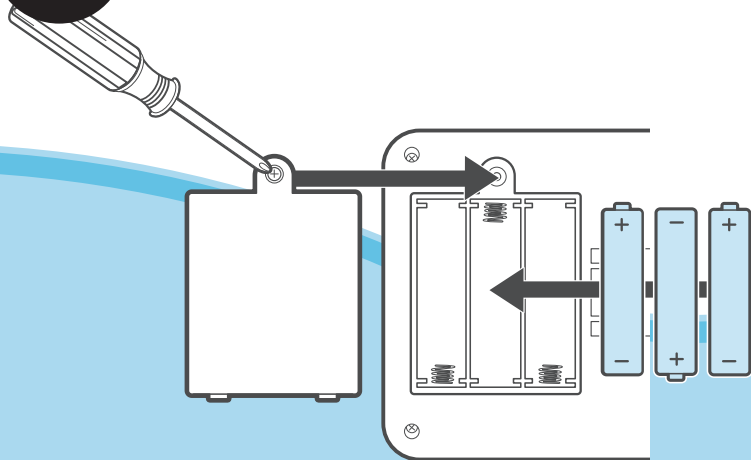

2

Insert 3 x 1.5V "AA" or R6 size batteries. Alkaline batteries recommended. Replace cover and tighten screw.



IMPORTANT: BATTERY INFORMATION

⚠ CAUTION:

1. Always follow the instructions carefully. Use only batteries specified and be sure to insert them correctly by matching the + and – polarity markings.
2. Do not mix old batteries and new batteries or standard (carbon-zinc) with alkaline batteries.
3. Remove exhausted or dead batteries from the product.
4. Remove batteries if product is not to be played with for a long time.
5. Do not short-circuit the supply terminals.
6. Should this product cause, or be affected by, local electrical interference, move it away from other electrical equipment. Reset (switching off and back on again or removing and re-inserting batteries) if necessary.
7. RECHARGEABLE BATTERIES: Do not mix these with any other types of batteries. Always remove from the product before recharging. Recharge batteries under adult supervision. **DO NOT RECHARGE OTHER TYPES OF BATTERIES.**

TO CREATE LITE BRITE PICTURE:

1

Tear the pattern sheets along the perforated lines and remove.

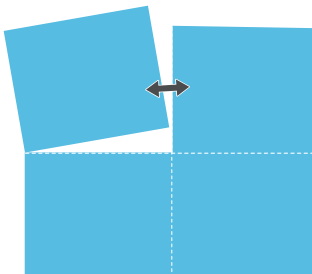

2

Place a pattern sheet flat and straight against the screen. Insert 4 pegs into the 4 corners of the sheet to hold the sheet in place.

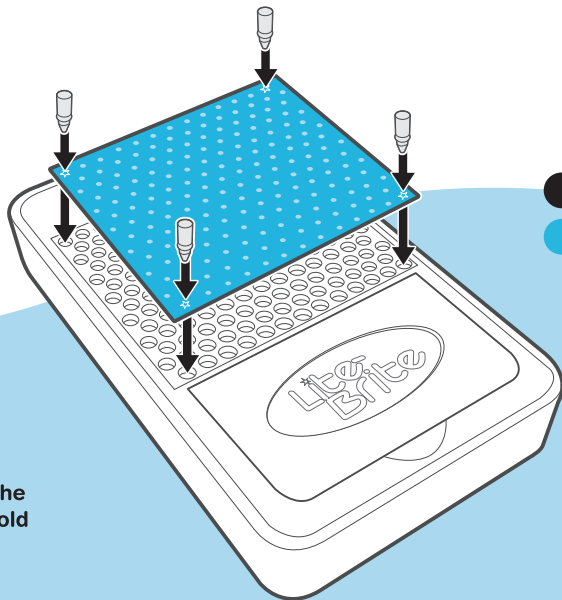

3

To create a picture, follow the printed letters on the sheet to tell which colored pegs to use. (see chart below).

O = ORANGE **R** = RED **G** = GREEN **P** = PINK
W = WHITE **B** = BLUE **Y** = YELLOW **V** = VIOLET

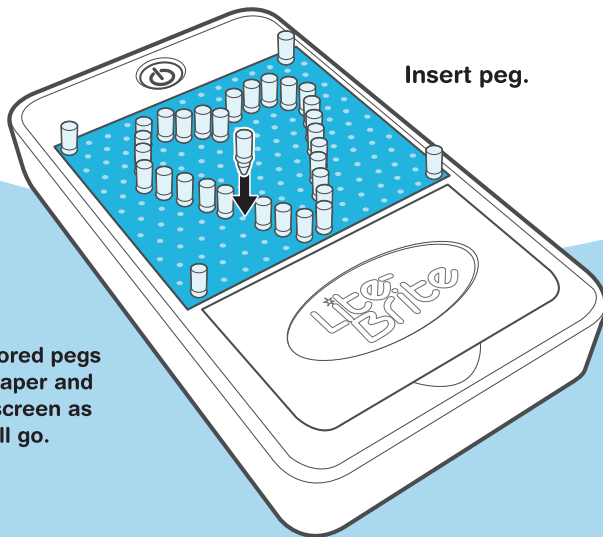

4

Insert the colored pegs through the paper and into the peg screen as far as they will go.

5

When you are finished pegging, press on the bottom of the toy to make your creations shine! The light will stay on for approximately 3 minutes each time you press the button, then turn off to conserve battery life.

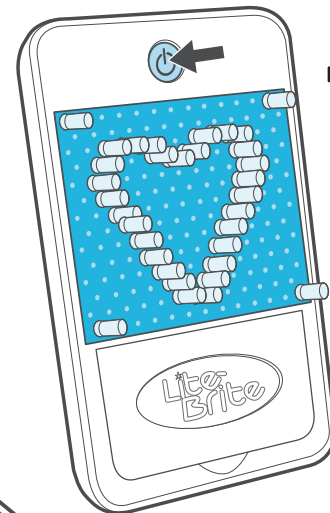
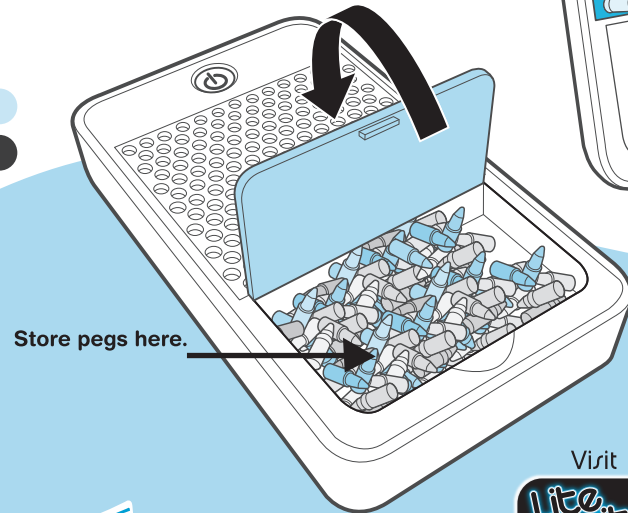

Available on the
App Store

Parents download the Lite-Brite® App from the App Store.



PN 7163750000

LITEBRITE.COM Questions? Call: 1-800-327-8264. Product and colors may vary.
© 2011 Hasbro. All Rights Reserved. TM and © denote U.S. Trademarks.